

#### General Description

Series BLS, high performance 3 piece stainless steel ball valve, pneumatically actuated, double acting or spring return.

15mm to 80mm bore (2 way). 15mm to 50mm bore (3 way).

Body connections with threaded (standard), butt weld, socket weld or flange.

Typical applications include water treatment, chemical, marine, petrochemical and general industrial.

#### Technical Specifications:

3-piece full bore 2 way (reduced bore for 3 way) 1000 psi WOG ball valve.

Self adjusting stem packing assembly with Belleville spring for temperature fluctuations and vibration.

ISO 5211 pad for direct mounting of actuator.

Pre-drilled metric hole with raised pads to minimise any thermal transfer from valve to actuator.

Investment casting: stainless steel.

Internal entry - blowout proof stem.

Connection: threaded, buttweld, socket weld.

Size: 1/2" - 4" (2 way) or 1/2" - 3" (3 way)

Optional reinforced PTFE seats for temperatures up to 180°C

Also available with electric actuator or manual lever.

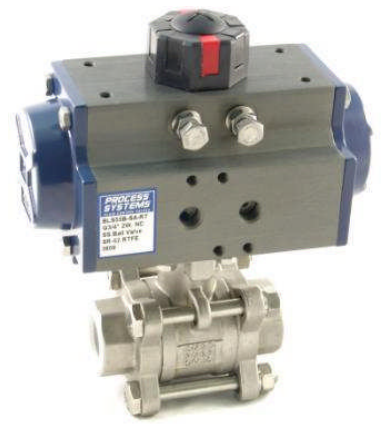

**IMPORTANT - Chemical Resistance.** For specific information on chemical resistance of valve components to various Liquids and Gases, refer to the manufacturer or your distributor. See over page for application warning.

It is the responsibility of the user to determine suitability of seat and body material to the application.

#### How to Order

<p><b>Series</b></p> <p>BLS</p>	<p>6</p>	<p>B</p>	<p>— DA —</p>	<p>RT</p>	<p>Optional Extras</p> <p>NAMUR Sol./Spring NS1215 NAMUR Sol./Sol. ND1215 Limit Switch - single or double All Plastic Actuator All Stainless Steel Actuator (Aluminium Actuator - standard)</p>																										
<p><b>Function</b></p> <p>5 - 2 way normally closed (single acting) 6 - 2 way normally open (single acting) 3L - 3 way L port 3T - 3 way T port</p>	<p><b>Port Connection</b></p> <p>B - BSPT (standard) BW - Butt Weld SW - Socket Weld FA - Flange ANSI (standard) FD - Flange DIN NPT - National Pipe Thread</p>			<p><b>Seals &amp; Seats</b></p> <p>T - PTFE RT - Reinforced PTFE</p>	<p><b>Pneumatic Operation</b></p> <p>DA - Double Acting SA - Single Acting (spring return)</p>																										
<p><b>Port size DN(mm) BSPT</b></p> <table border="1"> <tr><td>1/2"</td><td>15</td><td>4</td></tr> <tr><td>3/4"</td><td>20</td><td>5</td></tr> <tr><td>1"</td><td>25</td><td>6</td></tr> <tr><td>1-1/4"</td><td>32</td><td>7</td></tr> <tr><td>1-1/2"</td><td>40</td><td>8</td></tr> <tr><td>2"</td><td>50</td><td>9</td></tr> <tr><td>2-1/2"</td><td>65</td><td>10</td></tr> <tr><td>3"</td><td>80</td><td>11</td></tr> <tr><td>4"</td><td>100</td><td>12</td></tr> </table>	1/2"	15	4	3/4"	20	5	1"	25	6	1-1/4"	32	7	1-1/2"	40	8	2"	50	9	2-1/2"	65	10	3"	80	11	4"	100	12				
1/2"	15	4																													
3/4"	20	5																													
1"	25	6																													
1-1/4"	32	7																													
1-1/2"	40	8																													
2"	50	9																													
2-1/2"	65	10																													
3"	80	11																													
4"	100	12																													

**Ordering Example:** BLS6B - DA - RT 1" BSP 316S/S Ball valve c/w double acting pneumatic actuator.

**2 WAY / 3 WAY ST. STEEL BALL VALVE WITH PNEUMATIC ACTUATOR**

**Series  
BLS**

**2 WAY (FULL BORE)**

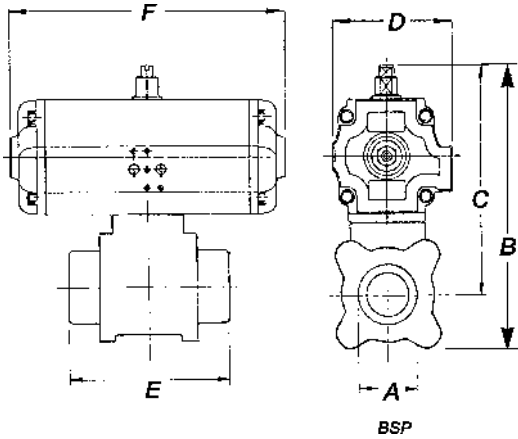

**VALVE MOUNTED ON DOUBLE ACTING ACTUATOR**

ISO PAD	FO3	FO3	FO5	FO5	FO5	FO5	FO7	FO7
A	1/2"	3/4"	1"	1-1/4"	1-1/2"	2"	2-1/2"	3"
B	144	160	175	195	205	228		
C	120	134	140	160	165	183		
D	45	71	71	80	80	80	106	106
E	74	83	94	105	120	136	168	189
F	115	173	173	196	196	196	250	250
ACT	DA32	DA52	DA52	DA63	DA63	DA63	DA85	DA85
kg	1.2	2.0	2.4	3.7	4.3	6.2		

**VALVE MOUNTED ON SPRING RETURN ACTUATOR**

ISO PAD	FO3	FO3	FO5	FO5	FO5	FO5	FO7	FO7
A	1/2"	3/4"	1"	1-1/4"	1-1/2"	2"	2-1/2"	3"
B	164	160	185	195	235	255		
C	140	134	150	160	195	210		
D	71	71	80	80	106	106	123	
E	74	83	94	105	120	136	168	189
F	173	173	196	232	250	250	297	
ACT	SR52	SR52	SR63	SR75	SR85	SR85	SR100	SR115
kg	1.9	2.0	2.4	3.7	4.3	6.2		

**3 WAY L PORT / T PORT (REDUCED BORE)**

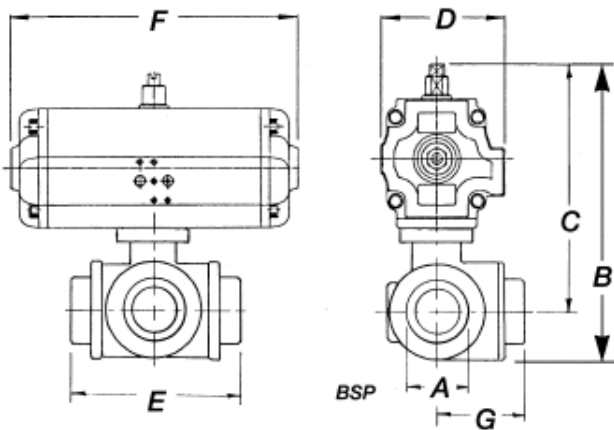

**VALVE MOUNTED ON DOUBLE ACTING ACTUATOR**

ISO PAD	FO3	FO3	FO5	FO5	FO5	FO5
A	1/2"	3/4"	1"	1-1/4"	1-1/2"	2"
B						
C						
D	71	71	71	80	80	106
E	75	86	103	115	125	146
F	173	173	173	196	232	250
G	46	46	53	62	70	83
ACT	DA52	DA52	DA52	DA63	DA75	DA85
kg	1.9	2.0	3.0	4.0	4.6	10.0

**VALVE MOUNTED ON SPRING RETURN ACTUATOR**

ISO PAD	FO3	FO3	FO5	FO5	FO5	FO5
A	1/2"	3/4"	1"	1-1/4"	1-1/2"	2"
B						
C						
D	71	80	80	80	106	123
E	75	86	103	115	125	146
F	173	196	196	232	250	297
G	39	44	53	62	70	83
ACT	SR52	SR63	SR63	SR75	SR85	SR100
kg	2.0	2.4	3.4	4.3	7.2	



THIS DATA SHEET CAN BE DOWNLOADED FROM OUR WEBSITE

**PROCESS SYSTEMS PTY LTD**  
A.B.N. 15 010 932 386

Email: [sales@processsystems.com.au](mailto:sales@processsystems.com.au)  
P.O. Box 2070 Wellington Pt. Qld. 4160  
Corner Lytton & Ramsay Rd. Hemmant, Brisbane  
Queensland 4174 Australia

Website: [www.valvesonline.com.au](http://www.valvesonline.com.au)  
Int. Fax +61 7 3890 3133  
Phone 1300 887 880 (6 lines)  
Int. Phone: +61 7 3890 3122

**WARNING**

These products are intended for use in industrial applications only. Do not use these products where pressures and temperatures can exceed those listed under "Technical Data" and in our individual 'Series' data sheets. Before using these products with fluids other than those specified, for non-industrial applications, life-support systems, or other applications not within published specifications, consult **Process Systems Pty Ltd.** Through misuse, age, or malfunction, components used in industrial valve applications can fail in various modes. The system designer is warned to consider the failure modes of all component parts used in industrial valve applications and to provide adequate safeguards to prevent personal injury or damage to equipment in the event of such failure. **System designers must provide a warning to the user in the system instructional manual if protection against a failure mode cannot be adequately provided.** System designers and end users are cautioned to review specific warnings or specifications found in instruction sheets or labels packed or attached and shipped with the products. Our policy is one of continuous research and development. We therefore reserve the right to amend without notice the specifications given in this document or our individual 'Series' data sheets.

**WARRANTY INFORMATION**

Series BLS and all other products manufactured or distributed by Process Systems Pty. Ltd. are warranted by Process Systems to be free of defects in material and workmanship for a period of 1 year from the date of purchase or as the manufacturer warrants. Process Systems obligation under this warranty is limited to repair or replacement of the defective product or refund of the purchase price paid solely at the discretion of Process Systems and provided such defective product is returned to Process Systems freight prepaid and upon examination by Process Systems such product is found defective. This warranty shall be void in the event that the product has been subject to misuse, misapplication, improper maintenance, modification or tampering. This warranty is expressed in lieu of all other warranties, expressed or implied from Process Systems Pty. Ltd. representatives or employees. Process Systems reserves the right to change Valve and Brochure specifications without notice.